

007856
R 0317

Zembrace SYMTOUCH™
(sumatriptan injection)
Instructions For Use

Zembrace SYMTOUCH™
(sumatriptan injection)
Instructions For Use

007856
R 0317

Instructions for Use | ZEMBRACE™ SymTouch™ (Zem-brace Sim-Touch) (sumatriptan succinate) Injection

Read this Instructions for Use before you start to use the ZEMBRACE™ SymTouch™. There may be new information. This information does not take the place of talking with your healthcare provider about your medical condition or treatment. You and your healthcare provider should talk about ZEMBRACE SymTouch when you start taking it and at regular checkups.

The ZEMBRACE SymTouch Autoinjector is a single-use, pre-filled injection device with the exact dose you need. The device should be used only 1 time and then discarded.

Important Precautions

- Keep out of reach of children.
- Do not** use after the expiration date has passed.
- Do not** store or expose to high temperatures.
- Do not** freeze.
- Do not** remove the Red Cap until you are ready to inject.
- Do not** use if dropped after removing the Red Cap.
- Do not** put or press thumb, fingers or hand over the Yellow Needle Guard.

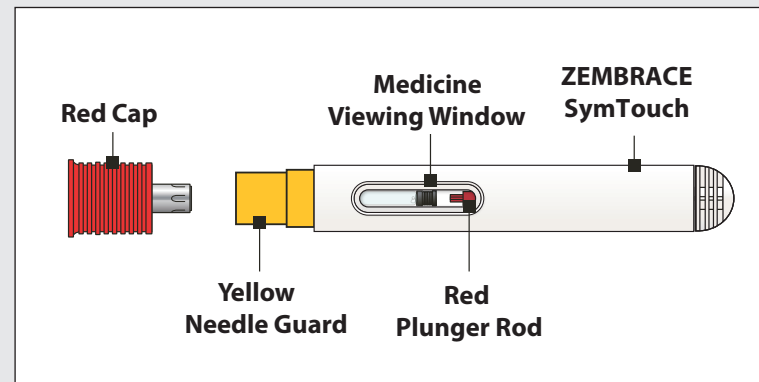

Step 1 - Inspect Autoinjector and Gather Supplies

- ▶ **1A - Remove Autoinjector from the carton**
- ▶ **1B - Check the Expiration Date on the Autoinjector**
- ▶ **1C - Inspect the medicine through the Medicine Viewing Window**
- ▶ **1D - Gather the following supplies**

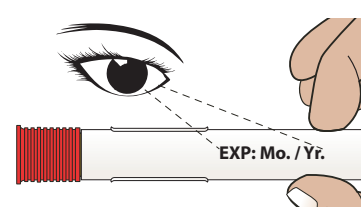

Do not use if the expiration date has passed.

Inspect the appearance of ZEMBRACE SymTouch Autoinjector medicine through the medicine viewing window. It must be a clear, colorless to pale yellow solution.

Do not inject the medicine if the solution looks discolored or cloudy or contains lumps, flakes, or particles.

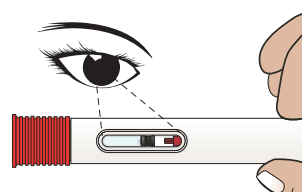

- 1. Autoinjector
- 2. Alcohol Swab
- 3. Sterile Cotton Ball or Gauze
- 4. Puncture-Resistant Sharps Container

ZEMBRACE SymTouch

Step 2 - Choose and Prepare Your Injection Site

- ▶ **2A - Choose your injection site**
- ▶ **2B - Clean the injection site with an alcohol swab**
- ▶ **2C - Remove the Red Cap**

The recommended injection sites are the sides of the thighs and the arms.

Injection Sites

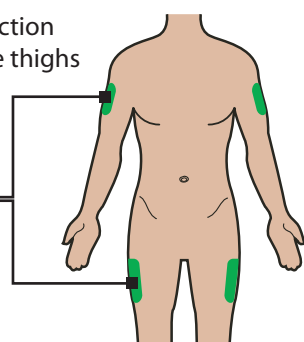

Caution: Do not inject where your skin is scarred, bruised, tender, red or near any open wound.

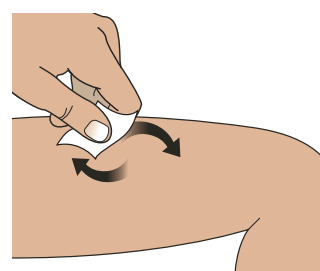

Do not touch injection site area after cleaning.

Hold the body of the Autoinjector in one hand and pull the Red Cap straight off.

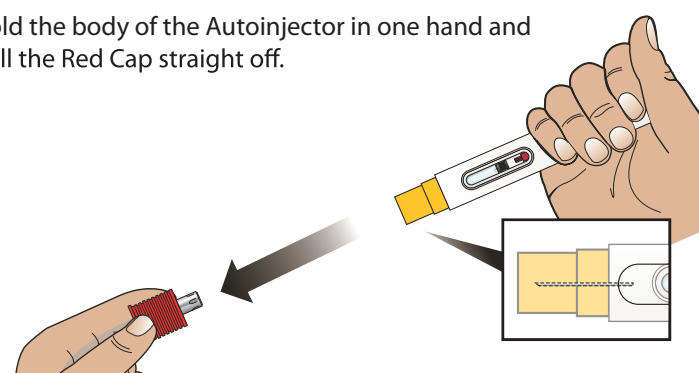

Warning: Do not put or press thumb, fingers or hand over the Yellow Needle Guard, doing so may result in a needle stick injury.

Step 3 - Inject the Medicine

- ▶ **3A - Place Autoinjector straight on your injection site**
- ▶ **3B - Perform Injection**
- ▶ **3C - Remove Autoinjector from skin**

Place the Autoinjector straight on your injection site (90 degrees) with the Yellow Needle Guard end gently pressed against your skin.

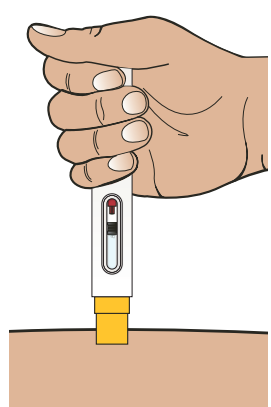

Press and hold the Autoinjector down against your skin. You will hear the first "Click 1" as the injection starts. Continue to hold the device down until you hear the second "Click 2."

Wait 5 seconds before you remove the Autoinjector!

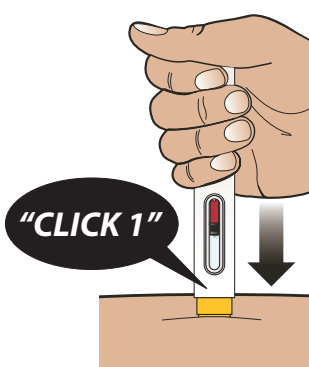

HOLD!



WAIT!

CONTINUE TO HOLD DOWN AND SLOWLY COUNT TO 5.

1...2...3...4...5

Remove the Autoinjector by lifting it straight away from your skin. The Yellow Needle Guard will drop down and lock over the needle.

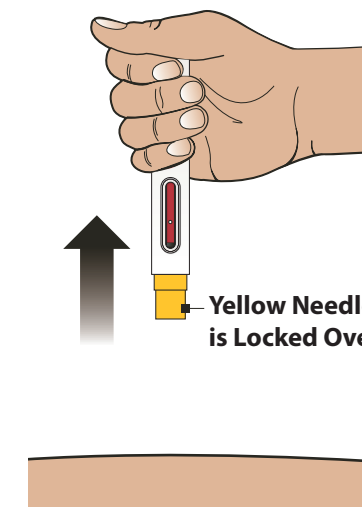

Important: To receive your full dose, always hold the Autoinjector down on your injection site for additional time after you hear the second click. This allows all of the medicine to be delivered.

Step 4 - Confirm Injection and Dispose the Autoinjector

- ▶ **4A - Confirm Red Color in Medicine Viewing Window**
- ▶ **4B - Disposal of the Autoinjector**
- ▶ **4C - Treat Injection Site**

Look to confirm that the Red Plunger Rod has filled the Medicine Viewing Window. This means you received the full dose.

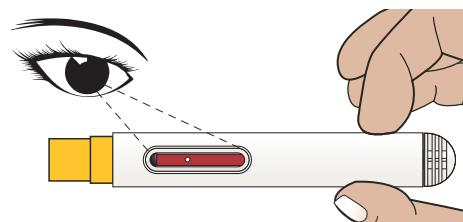

Caution: Call your healthcare provider if the Red Plunger Rod has not filled the Medicine Viewing Window. This may mean that only a partial dose was delivered.

Do not try to reuse the Autoinjector.

Put your used Autoinjector, caps, needles, and sharps in an FDA-cleared sharps disposal container right away after use. Do not throw away (dispose of) loose needles and syringes in your household trash. Do not recycle your used sharps disposal container.

If you do not have a FDA-cleared sharps disposal container, you may use a household container that is: made of a heavy-duty plastic; can be closed with a tight-fitting, puncture-resistant lid, without sharps being able to come out; upright and stable during use; leak-resistant; and properly labeled to warn of hazardous waste inside the container.

When your sharps disposal container is almost full, you will need to follow your community guidelines for the right way to dispose of your sharps disposal container. There may be state or local laws about how you should throw away used needles and syringes. For more information about safe sharps disposal, and for specific information about sharps disposal in the state that you live in, go to the FDA's website at: <http://www.fda.gov/safesharpsdisposal>.

Do not dispose of your used sharps disposal container in your household trash unless your community guidelines permit this. Do not recycle your used sharps disposal container.

If needed, make sure you get a refill of your Autoinjector.



Treat the injection site with a cotton ball, gauze pad or bandage, as needed.

Do not rub the injection site.

ZEMBRACE SymTouch are registered trademarks of Dr. Reddy's Laboratories, Ltd.

PROMIUS™
PHARMA

This Instructions for Use has been approved by the U.S. Food and Drug Administration.

Mar 2017

Dr.Reddy's PHARMA		JOB INFORMATION		HISTORY		COLORS	
The power of humans being		NAME: Zembrace IFU	AS Rev-0: 3-28-17	Rev-6:	BLACK	Outline	
		ITEM#: 007856	AS Rev-1: 4-4-17	Rev-7:	Yellow	Varnish	
		MARKET: USA	AS Rev-2: 4-21-17	Rev-8:	PMS 123	Measurement Info.	
		DIELINE: DIE 448033-1	Rev-3:	Rev-9:	PMS 186	Coating Free	
		DIMENSIONS: Flat 11 x 21-1/2", Folded 4-1/2 x 1-13/16"	Rev-4:	Rev-10:	SUBSTRATE	Quiet Zone Indicator	
			Rev-5:	Rev-11:	VARNISH		
Approver	Name (print)	Signature		Date			
PD							
RA							
MKT							
QA							
SC							